

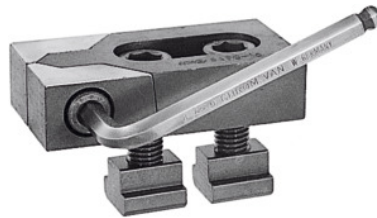

Pair of low height clamping jaws Bulle with accessories, Slot width a: 12 mm



Order data

Order number	375110 12
GTIN	4020772072957
Item class	35A

Description

Version:

Flat design, no protruding T-bolts. Clamps at any angle to table slot. When the side screw is tightened, the component is securely clamped down on to the table by the wedge effect.

Application:

For lateral clamping of flat plates directly on the machine table.

Material:

Hardened steel, burnished finish.

Supplied with:

2 fastening screws, DIN 912, 10.9, T-nuts, and hexagon key L-wrench ISO 2936 C.

Note:

Only supplied in pairs!

Length: 80 mm

Width: 40 mm

Height: 20 mm

for clamping screws: M10

Technical description

for clamping screws	M10
Length	80 mm
Height	20 mm

Width	40 mm
Slot width a	12 mm
Type	6490
Type of product	Side clamps