

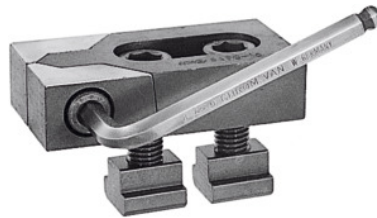

## Pair of low height clamping jaws Bulle with accessories, Slot width a: 18 mm



### Order data

Order number	375110 18
GTIN	4020772072995
Item class	35A

### Description

#### Version:

Flat design, no protruding T-bolts. Clamps at any angle to table slot. When the side screw is tightened, the component is securely clamped down on to the table by the wedge effect.

#### Application:

**For lateral clamping of flat plates** directly on the machine table.

#### Material:

Hardened steel, burnished finish.

#### Supplied with:

2 fastening screws, DIN 912, 10.9, T-nuts, and hexagon key L-wrench ISO 2936 C.

#### Note:

Only supplied in pairs!

Length: 100 mm

Width: 50 mm

Height: 25 mm

for clamping screws: M16

### Technical description

for clamping screws	M16
Width	50 mm
Slot width a	18 mm

Height	25 mm
Length	100 mm
Type	6490
Type of product	Side clamps